

WOOD CHIPPER

Assembly

► Model: DCH7

⚠ WARNING



ALWAYS READ THE USER MANUAL CAREFULLY AND FOLLOW THE SAFETY INSTRUCTIONS

Scan to view the installation video.

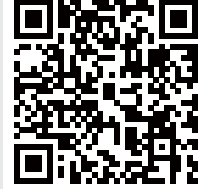

Required

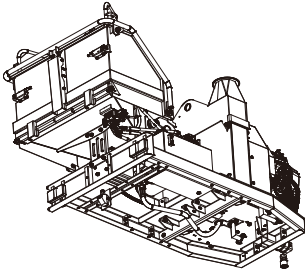

Engine and base frame

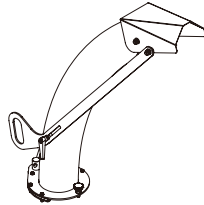

Lower discharging chute



Fuel tank



Mudguard



Axle



Tow bar and Guiding wheel



Wheels

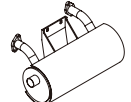

Muffler

01. Axle

Attach the torsion axle to the chassis using a Flat washer 12 (A), M12X30 hex bolt (C), and Spring washer 12 (B).

Attach the wheel to the torsion axle using a flange spherical nut.

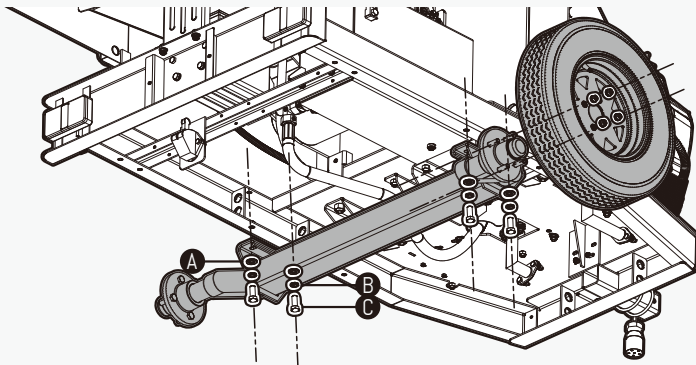

A Flat washer 12	x 4
B Spring washer 12	x 4
C Hex bolt M12 X 30mm	x 4

02. Tow bar and Guiding wheel

Attach the tow bar to the chassis using a M12x80 hex bolt (C), Flat washer 12 (A), and M12 lock nut (B).

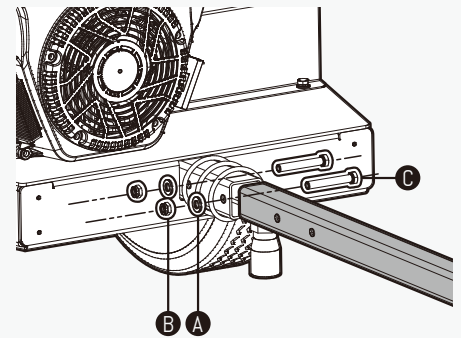

A Flat washer 12	x 2
B Hex lock nut M12	x 2
C Hex bolt M12 X 80mm	x 2

03. Muffler

Attach the muffler gasket between Exhaust Pipe 2, Exhaust Pipe 1, and the muffler.

Secure the muffler to Exhaust Pipe 2 and Exhaust Pipe 1 using Hex Bolt M8x30 (A), Flat Washer 8 (B), Spring Washer 8 (C), and Hex Nut M8 (D).

Attach the muffler to the chassis using Hex Bolt M8x20 (E), Flat Washer 8 (B), Spring Washer 8 (C), and Hex Nut M8 (D).

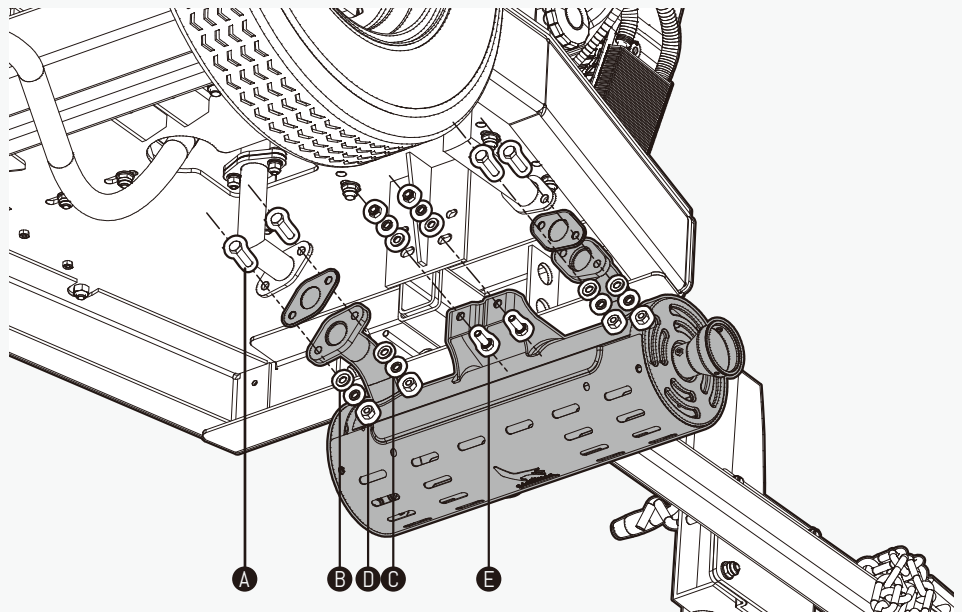

A Hex bolt M8 X 30mm	x 4
B Flat washer 8	x 6
C Spring washer 8	x 6
D Hex lock nut M8	x 6
E Hex bolt M8 X 20mm	x 2

04. Fuel tank

1. Secure the fuel tank bracket to the base using U-bolts, Flat Washers 8 (A), and M8 nuts (B).
2. Install the fixed shaft onto the base using an M8x35 hex bolt (C), Flat Washer 8 (A), and an M8 nut (B).
3. Mount the fuel tank onto the fuel tank bracket and the fixed shaft using an M8x35 hex bolt (C) and Flat Washer 8 (A).

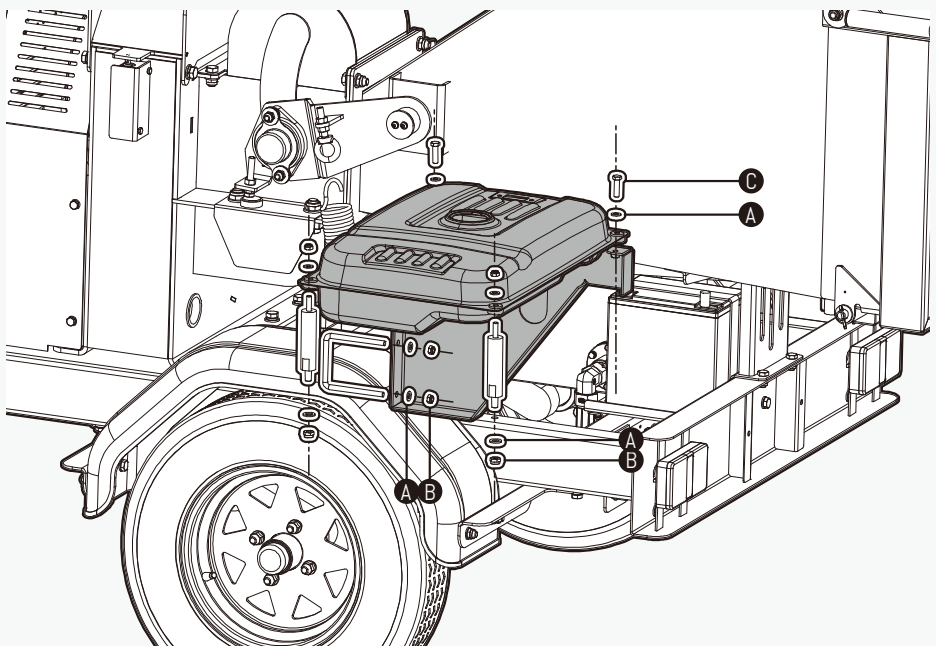

A	Flat washer 8	 x 8
B	Hex lock nut M8	 x 8
C	Hex bolt M8 X 35mm	 x 2

05. Mudguard

- Attach mudguard bracket 1 and mudguard bracket 2 to the chassis using M10x25 bolts (A), spring washer 10 (C), and flat washer 10 (B).
- Attach the mudguard to mudguard bracket 1 and mudguard bracket 2 using M10x25 bolts (A), flat washer 10 (B), and lock nut M10 (D).

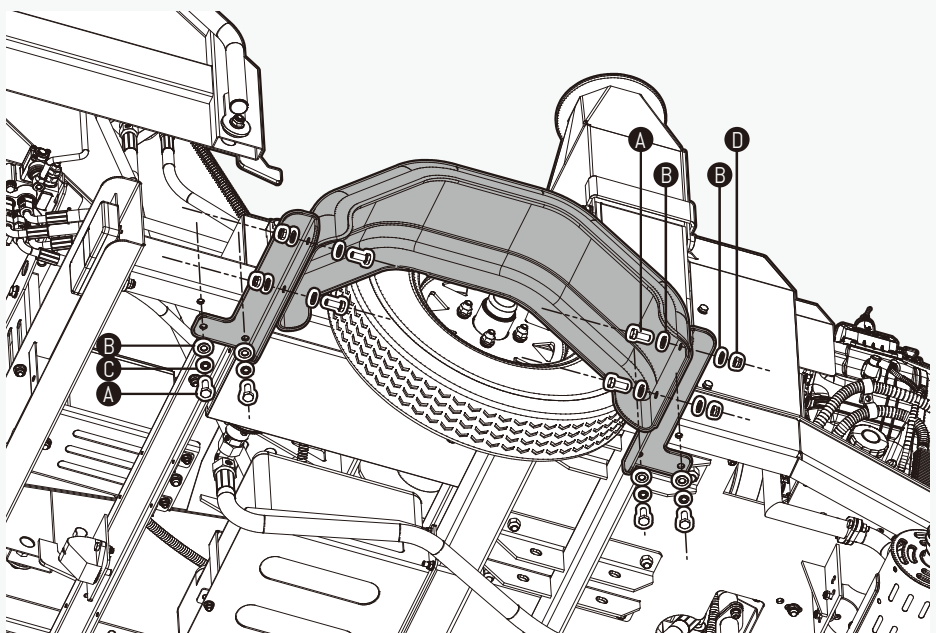

A	Hex bolt M10 X 25mm	 x 6
B	Flat washer 10	 x 6
C	Spring washer 10	 x 6
D	Hex lock nut M10	 x 4

06. Discharge Chute

- Attach the discharge chute to the chipper disc cover using M6 x 30 hex bolts (C), M6 lock nuts (B), and Flat washer 6 (A).

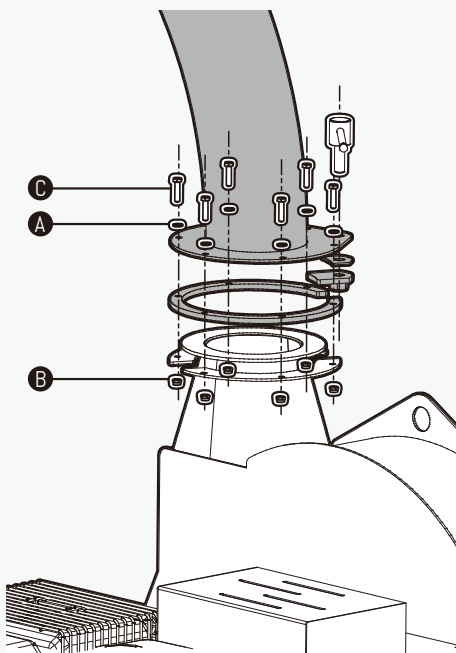

A	Flat washer 6	 x 6
B	Hex lock nut M6	 x 6
C	Hex bolt M6 X 30mm	 x 6

07. Connect the oil pipe to the engine

